

Article number: 01 693 06 99

## Exposed wash basin tap VITUS VW-EH-M Mixed water

Manual single-lever actuation.

### Scope of delivery

- Single-lever exposed wash basin tap
  - Operating handle made from brass
  - 2 backflow preventers (EN 1717: EB-type)
  - Valve for carrying out manual thermal disinfection (in accordance with DVGW worksheet W 551)
  - Single-lever mixing ceramic cartridge with hot water and flow restrictor
  - Pivoting outlet (lockable) with aerator
- 2 S-connections and rosettes (depth-adjustable)

### Technical data

- S\_Durchfluss: max. 5 l/min pressure independent
- Flow pressure: 1.0 - 5.0 bar
- Max. Resting pressure: 8 bar
- Max. operating temperature: 70 °C (80 °C for thermal disinfection)
- Connection: 2x DN 15 G 1/2 AG
- Material: Outlet Brass, conform to German drinking water regulations, Housing Brass, conform to German drinking water regulations
- Surface: Chrome
- Projection to centre of aerator: 330 mm
- Certificates: Belgaqua

### Delivery data

- Weight: 5,15 kg/Piece
- Packing unit: 1

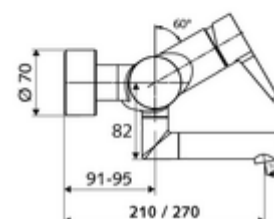
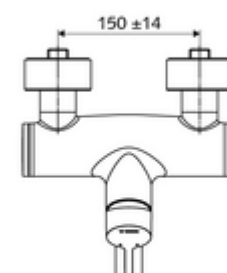
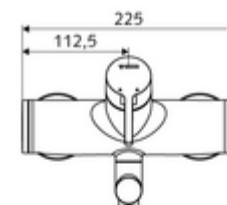

### Recommended associated articles

S-connecting with isolating valve	Article no: 23 775 00 99	
Wash basin outlet valve OPEN	Article no: 02 002 06 99	or
Wash basin outlet valve PUSH OPEN	Article no: 02 000 06 99	or

### Hint

- Discontinued article, as long as stocks last