

Article number: 01 693 06 99

Exposed wash basin tap VITUS VW-EH-M

Mixed water

Manual single-lever actuation.

Scope of delivery

- Single-lever exposed wash basin tap
 - Operating handle made from brass
 - Valve for carrying out manual thermal disinfection (in accordance with DVGW worksheet W 551)
 - Single-lever mixing ceramic cartridge with hot water and flow restrictor
 - 2 backflow preventers (EN 1717: EB-type)
 - Pivoting outlet (lockable) with flow regulator
- 2 S-connections and rosettes (depth-adjustable)

Technical data

- Flow: max. 5 l/min pressure independent
- Flow pressure: 1.0 - 5.0 bar
- Max. Resting pressure: 8 bar
- Max. operating temperature: 70 °C (80 °C for thermal disinfection)
- Connection: 2x DN 15 G 1/2 AG
- Material: Outlet Brass, conform to German drinking water regulations; Housing Brass, conform to German drinking water regulations
- Surface: Chrome
- Projection to centre of aerator: 330 mm
- Certificates: Belgaqua

Delivery data

- Weight: 5,15 kg/Piece
- Packing unit: 1

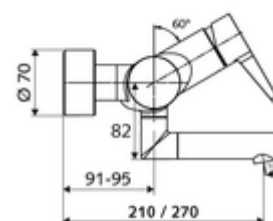
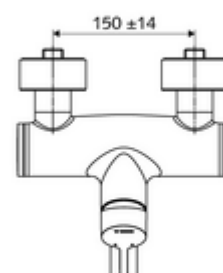
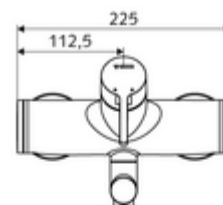

Recommended associated articles

| | | |
|-----------------------------------|--------------------------|----|
| S-connecting with isolating valve | Article no: 23 775 00 99 | |
| Wash basin outlet valve OPEN | Article no: 02 002 06 99 | or |
| Wash basin outlet valve PUSH OPEN | Article no: 02 000 06 99 | or |

Hint

- Discontinued article, as long as stocks last