

Article number: 01 653 06 99

Exposed wash basin tap VITUS VW-EH-M

Mixed water

Manual single-lever actuation.

Scope of delivery

- Single-lever exposed wash basin tap
 - Operating handle made from brass
 - Valve for carrying out manual thermal disinfection (in accordance with DVGW worksheet W 551)
 - Single-lever mixing ceramic cartridge with hot water and flow restrictor
 - 2 backflow preventers (EN 1717: EB-type)
 - Pivoting outlet (lockable) with flow regulator
- 2 S-connections and rosettes (depth-adjustable)

Technical data

- Flow: max. 5 l/min pressure independent
- Flow pressure: 1.0 - 5.0 bar
- Max. Resting pressure: 8 bar
- Max. operating temperature: 70 °C (80 °C for thermal disinfection)
- Connection: 2x DN 15 G 1/2 AG
- Material: Outlet Brass, conform to German drinking water regulations; Housing Brass, conform to German drinking water regulations
- Surface: Chrome
- Projection to centre of aerator: 210 mm
- Certificates: PA-IX 38238/IO, Belgaqua
- Noise class: I
- Flow class: O

Delivery data

- Weight: 4,79 kg/Piece
- Packing unit: 1

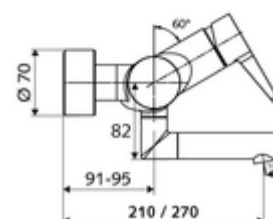
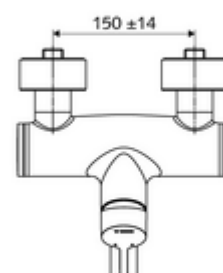
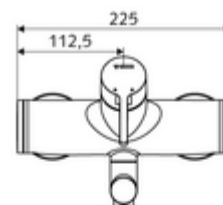

Recommended associated articles

S-connecting with isolating valve	Article no: 23 775 00 99	
Wash basin outlet valve OPEN	Article no: 02 002 06 99	or
Wash basin outlet valve PUSH OPEN	Article no: 02 000 06 99	or